

# M132 MIRCOGUN



**TOTAL PERFORMANCE**



Classic Army  
USA Page



Classic Army  
Official Page

**HIGH QUALITY AIRSOFT PRODUCTS**

[www.classicarmy.com](http://www.classicarmy.com)

[www.classicarmyusa.com](http://www.classicarmyusa.com)

[info@classicarmy.com](mailto:info@classicarmy.com)

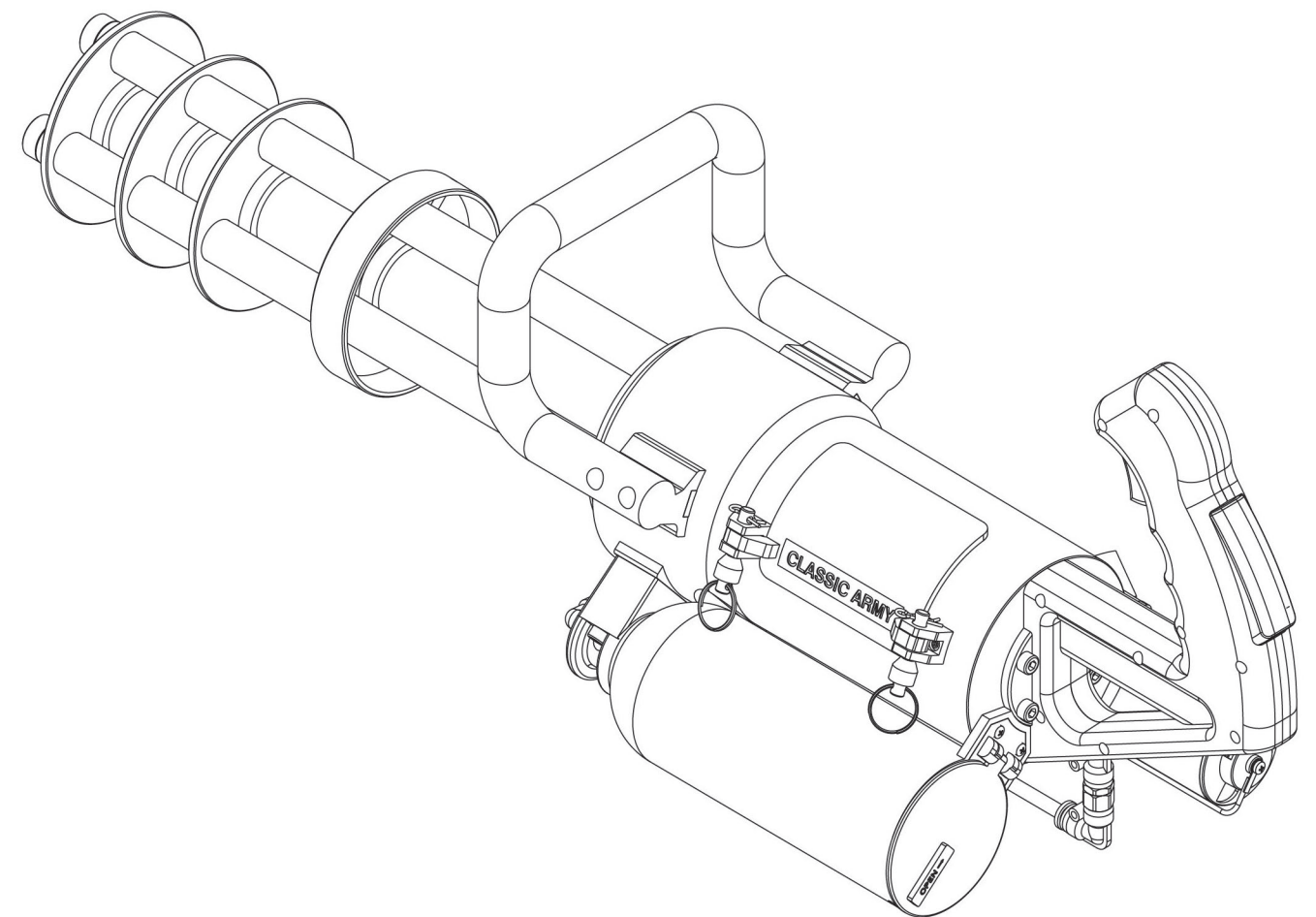

## WARNING

- FOR AGE 18 OR ABOVE.
- PLEASE READ THE INSTRUCTIONS CAREFULLY BEFORE USE.  
MISUSE OR CARELESS USE MAY CAUSE SERIOUS INJURY.
- USER SHOULD OBEY TO THE LAW REGARDING THE USAGE AND  
OWNERSHIP OF AIRSOFT ELECTRIC GUNS
- FACIAL PROTECTION IS REQUIRED

**Produced By Classic Army, Hong Kong**

## 1 Outlook/Structure

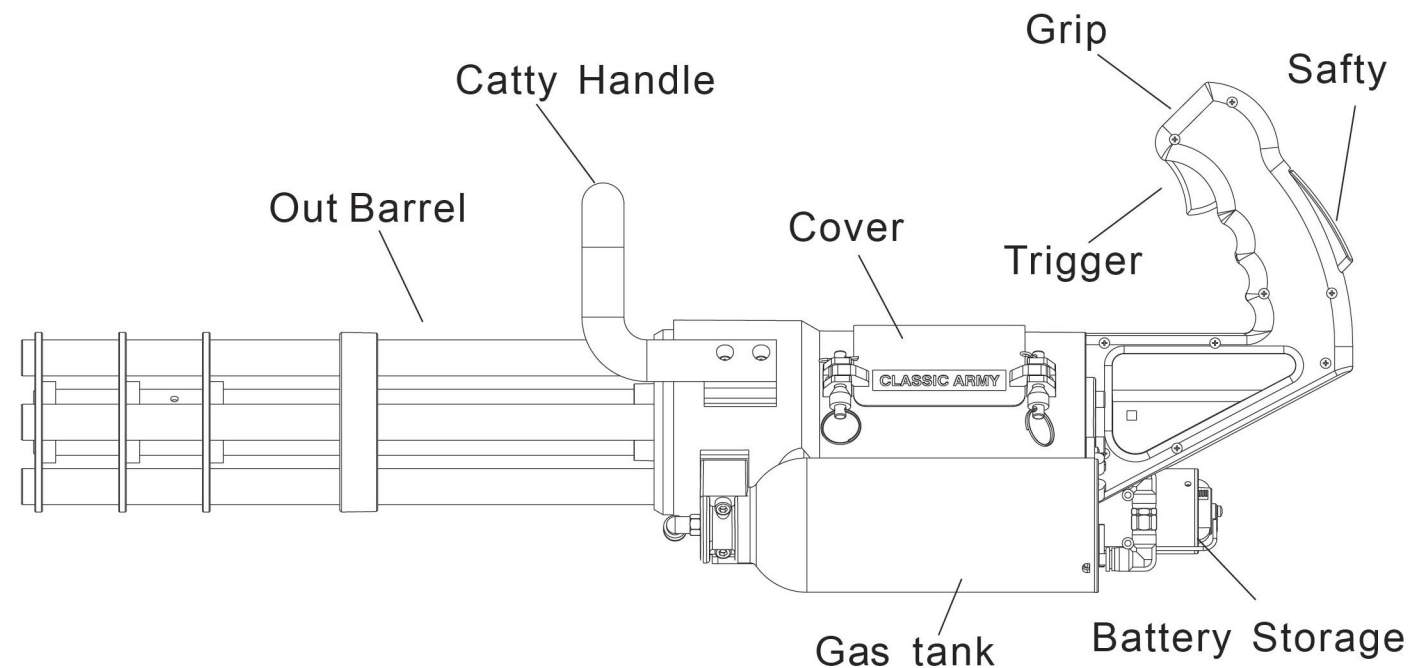

## 2 Specification

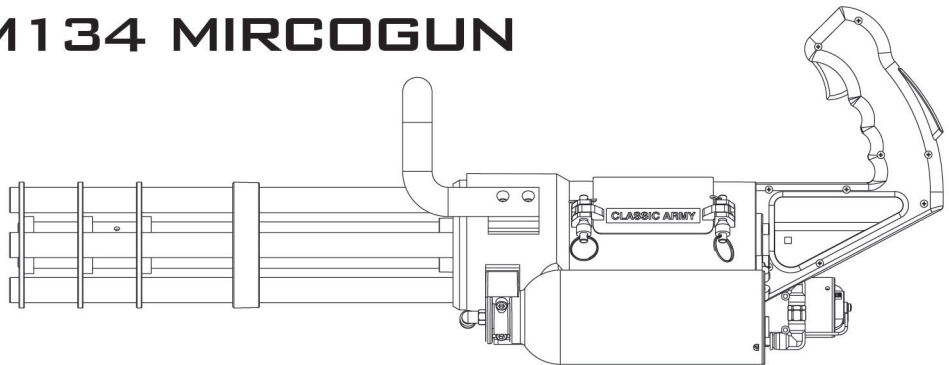
Data of Automatic Electric Gun	
Name	<b>M134 MIRCOCUN</b> 
Weight	4.5kg
Barrel Length	350mm
Barrel Caliber	6.03mm
Pellet Capacity	2200
Pellet	6mm BB
Initial Pellet Speed	110-135m/s
Battery Type	Large Type (12V)
Air Pressure	≤120ps i

## 3 Unpacking assembly

1. Insert the carry handle into the slots in the both side. lock both sides with 4 screws(2 for each side)

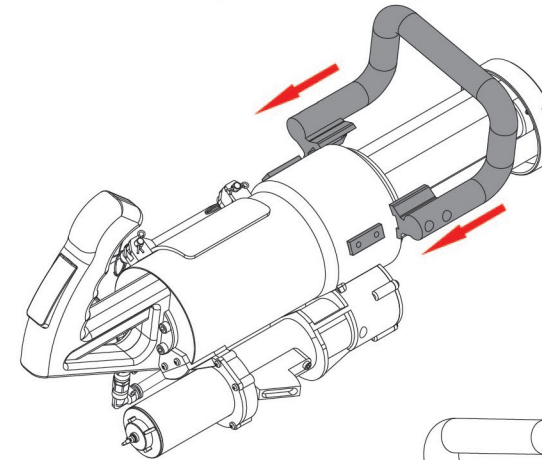

2. ① Connect the 3 wires with the same color.  
② Connect the 2 tube with the same connectors.

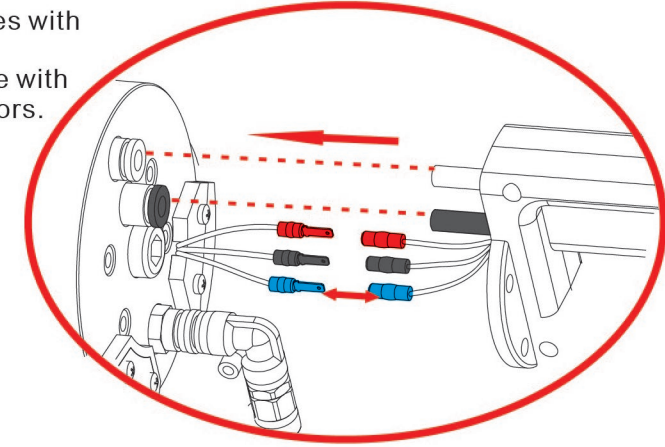

3. Connected wires and tubes and push grip to fit body. aim to 4 screw holes and tight 4 screws M5\*12 by screw driver.

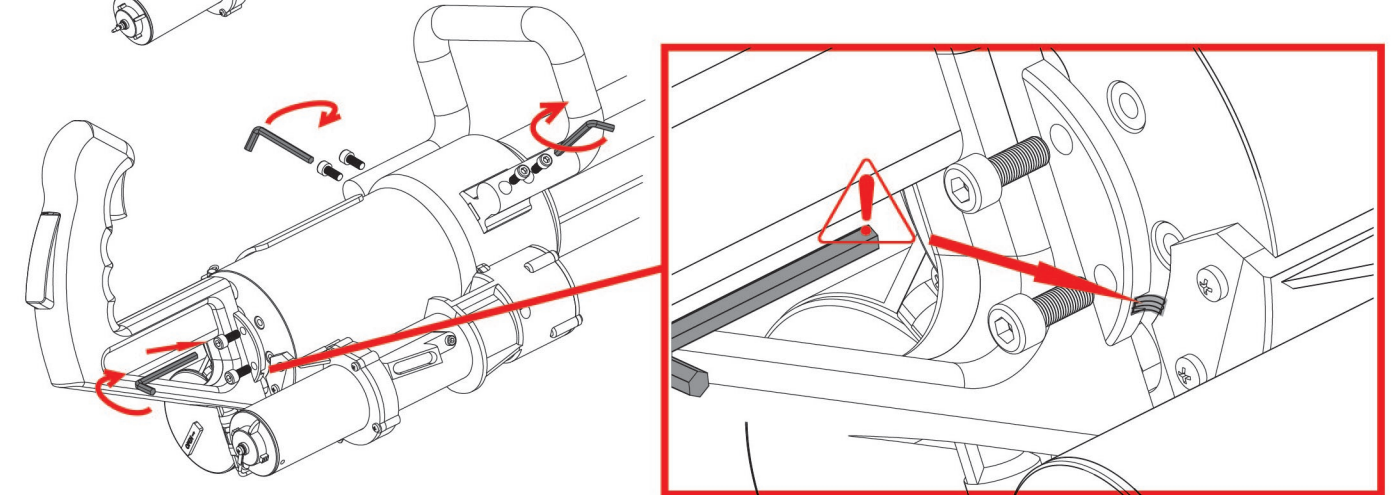

## 4 How to insert battery

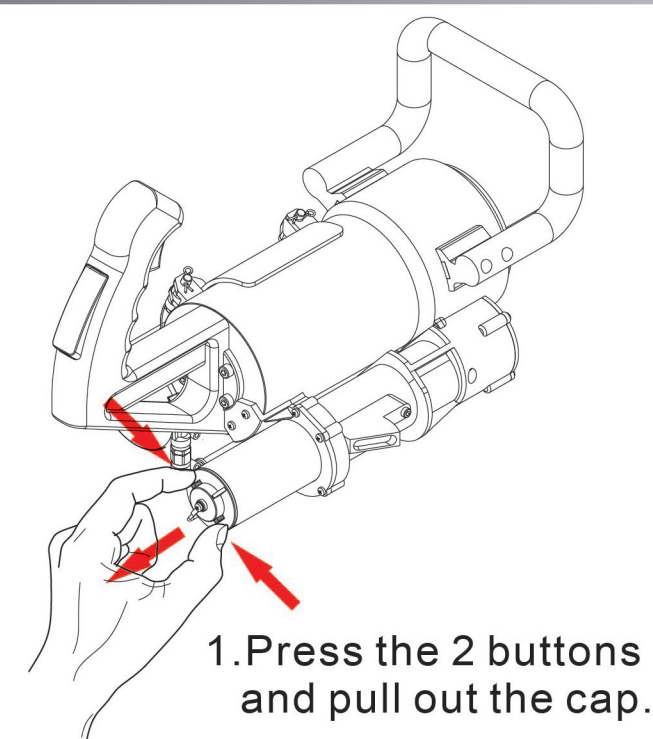

1. Press the 2 buttons and pull out the cap.

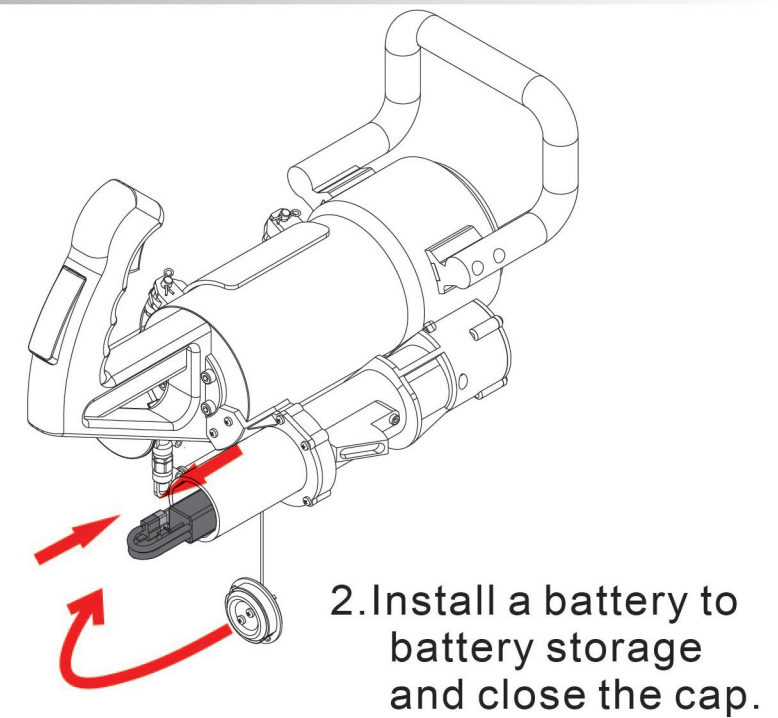

2. Install a battery to battery storage and close the cap.



## 5 Gas installation

1. Push the bottom in the direction of the arrow and open the cap.

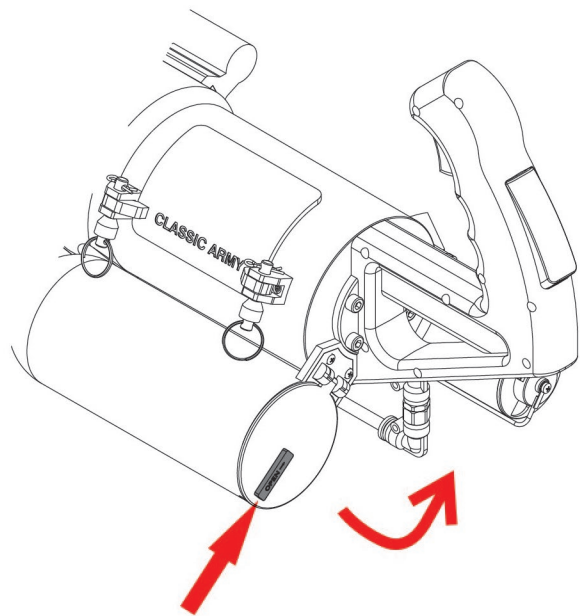

2. Insert the gas bottle to the bottom and tight clockwise quickly.

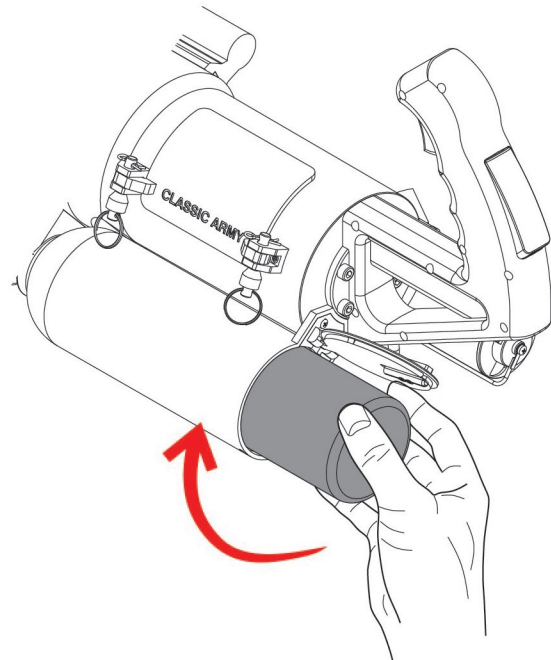

## 6 Magazine Attachment/Detachment Procedure

1. Open the lid counterclockwise and take it out

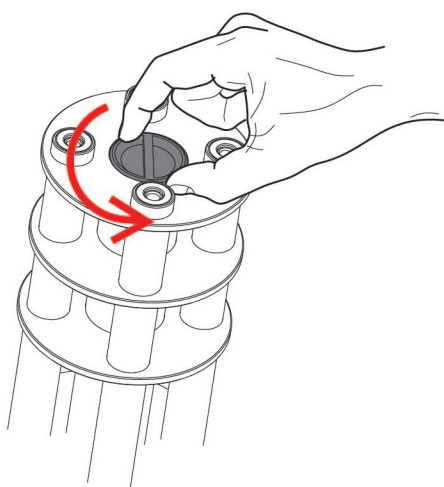

2. Load BBS.  
Do not load over the warning hole, otherwise the lid can't be closed.

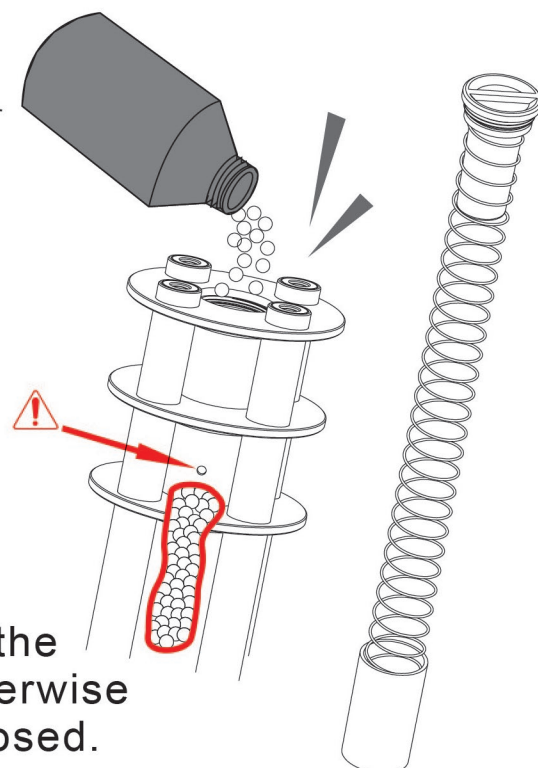

3. Press the spring into the tube and insert it, into the slot and tight it clockwise.

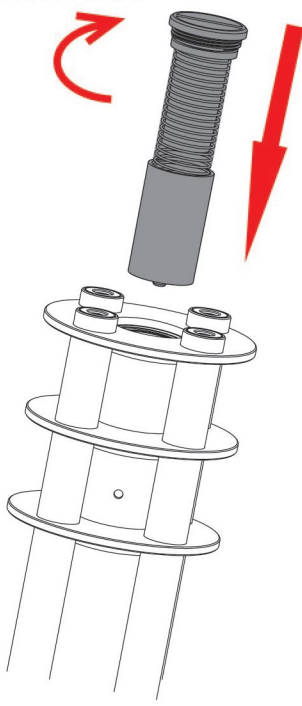

## 7 How to adjust the Hop-up system

1. Pull out the pin and open the cover.

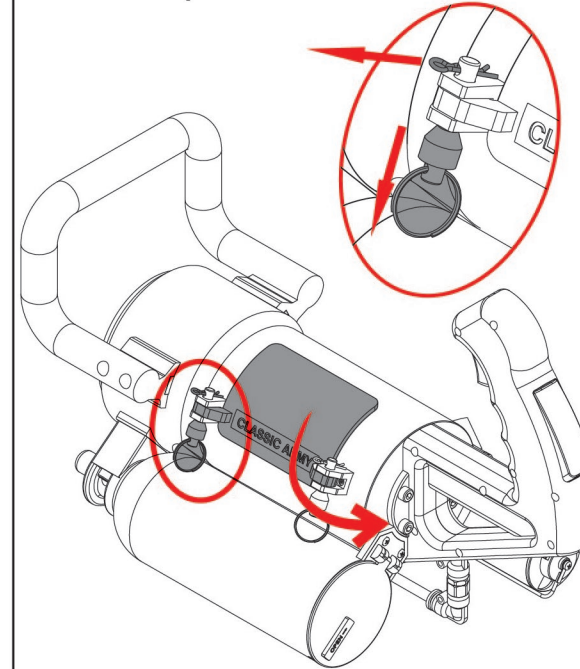

2. Turn out barrel and aim at the adjustment Hop-up hole, you can see the adjustment Hou-up screw inside the hole, use a screw driver to tight or loosen the Hop-up screw.

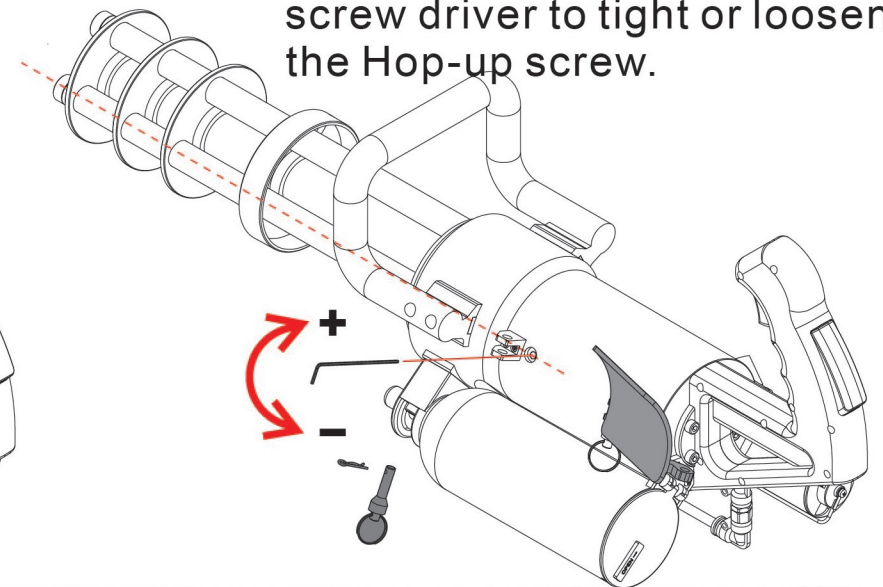

## 8 How to use a cleaning rod

### Maintenance

#### 1 How to use a cleaning rod



Cut a cotton cloth to the size as shown above and insert one end into the hole in the rod. (Adjust the length of cloth for smooth entry into the barrel.)



CAUTION: Always begin the maintenance by returning the hop up adjustment lever to NORMAL.



CAUTION: The chamber is a precision component. Never use any used BB pellets.

\* The hop-up performance may become unstable for 60 to 70 pellets after maintenance.

1 Spray silicone oil for 0.5 to 1 sec in the pellet entrance, then fire 40 to 50 pellets to make the magazine stable.

2 Clean the oil from the chamber using the cleaning rod (with cotton) to complete the maintenance.

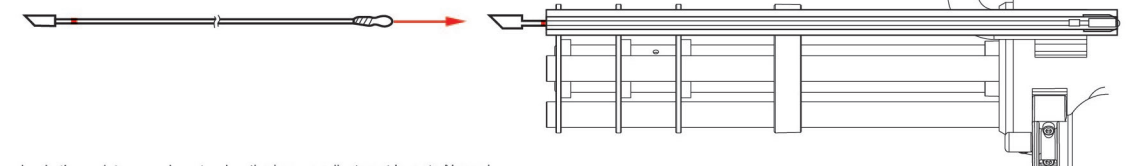

CAUTION: Always begin the maintenance by returning the hop up adjustment lever to Normal.

**CAUTION** Never use any used BB pellets

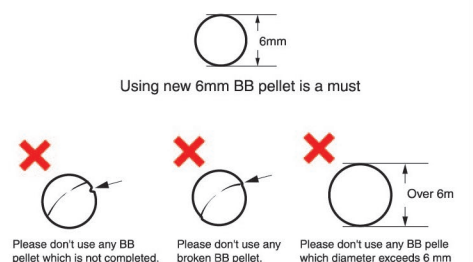



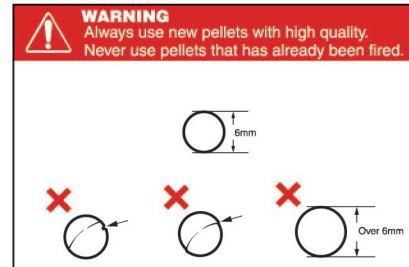

In no event shall DT-TECH or any of our partners be liable for any direct or indirect, special, incidental or consequential damages in connection with the use of our products

- 10** For complete product information, dealer locations and technical support, please visit the website of Classic Army Sole Distributors.